

The North, South, and West walls are white drywall; the entire East Wall is brick, with two vertical windows that measure 2-ft-wide by 10-ft-tall.

#### Equipment:

- Ceiling mounted lighting grid, with programmable lighting board.
- Two mountable digital projectors: BenQ MH750 and BenQ EH600
- CD and DVD players
- Macintosh laptop, software includes Pro Tools and QLab.
- 4 Mackie speakers with ceiling mounts
- Various audio output devices

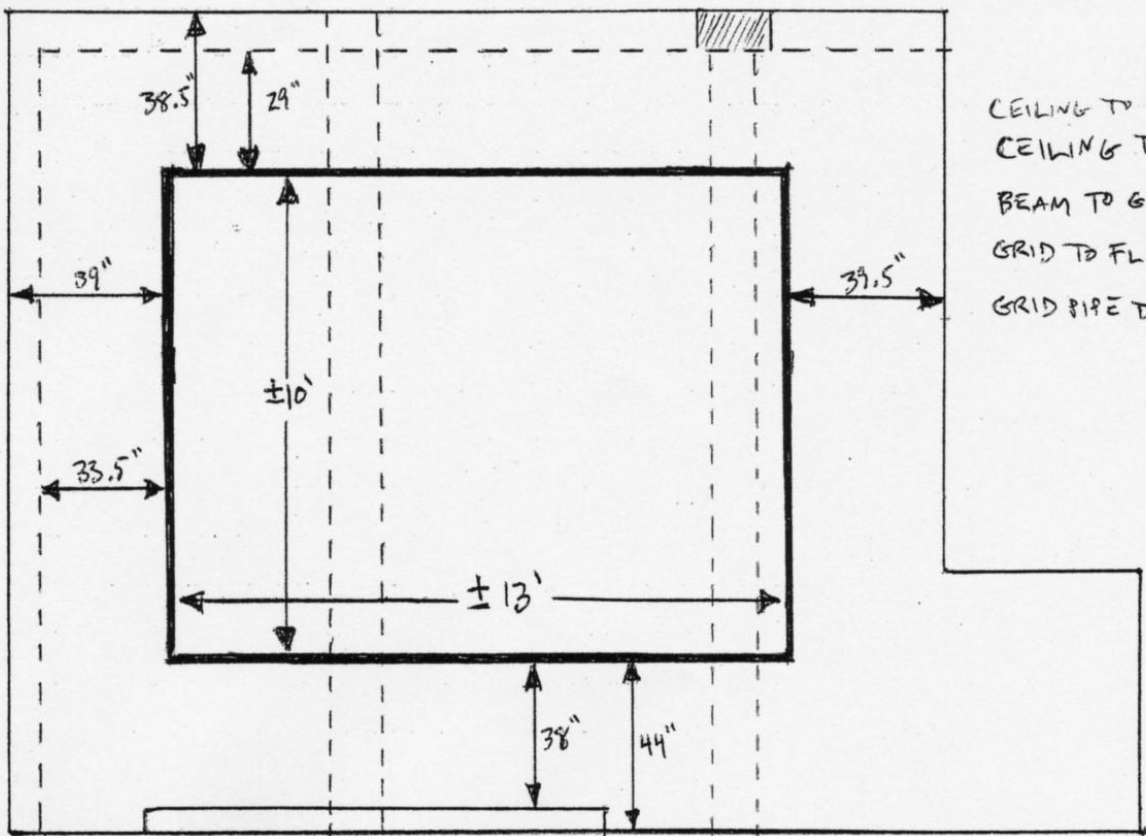
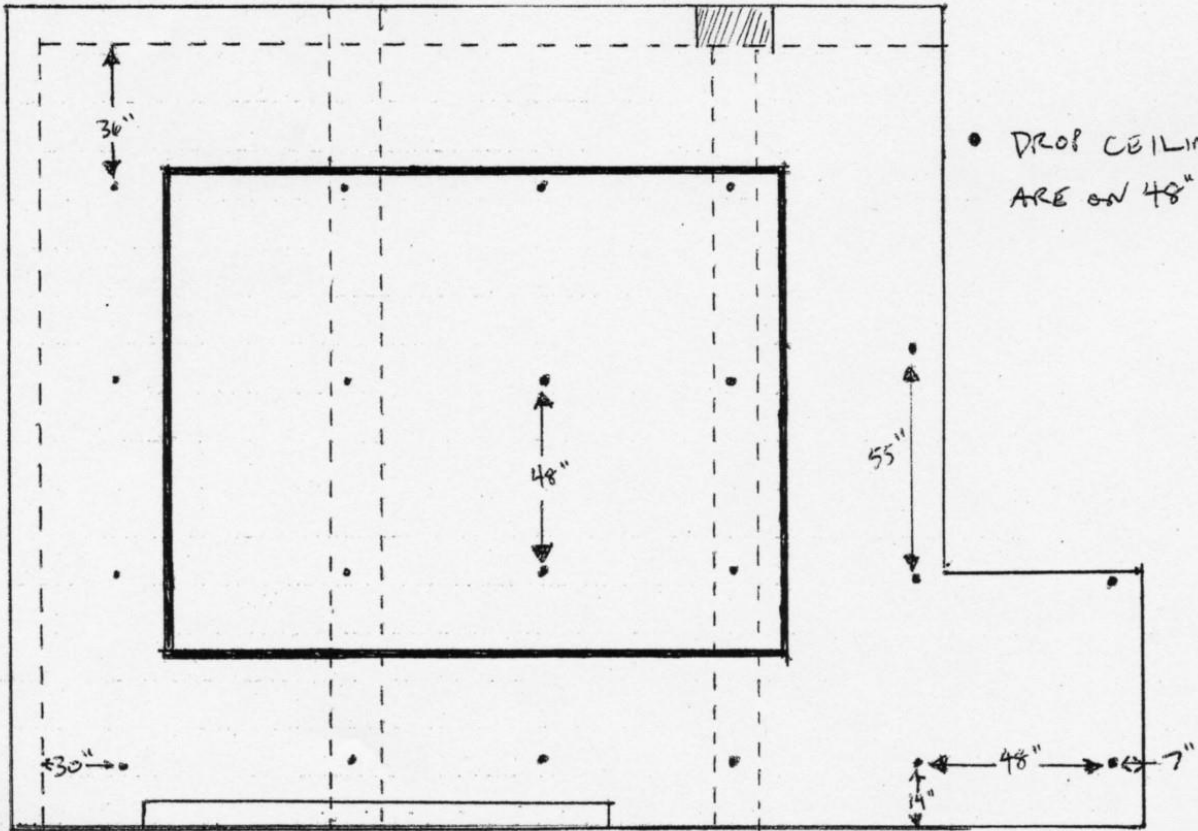

CEILING TO FLOOR = 16' 7"  
 CEILING TO GRID = ± 42"  
 BEAM TO GRID = ± 25"  
 GRID TO FLOOR = ± 13"  
 GRID PIPE DIAM. = 1 5/8"